

Cromarty Firth

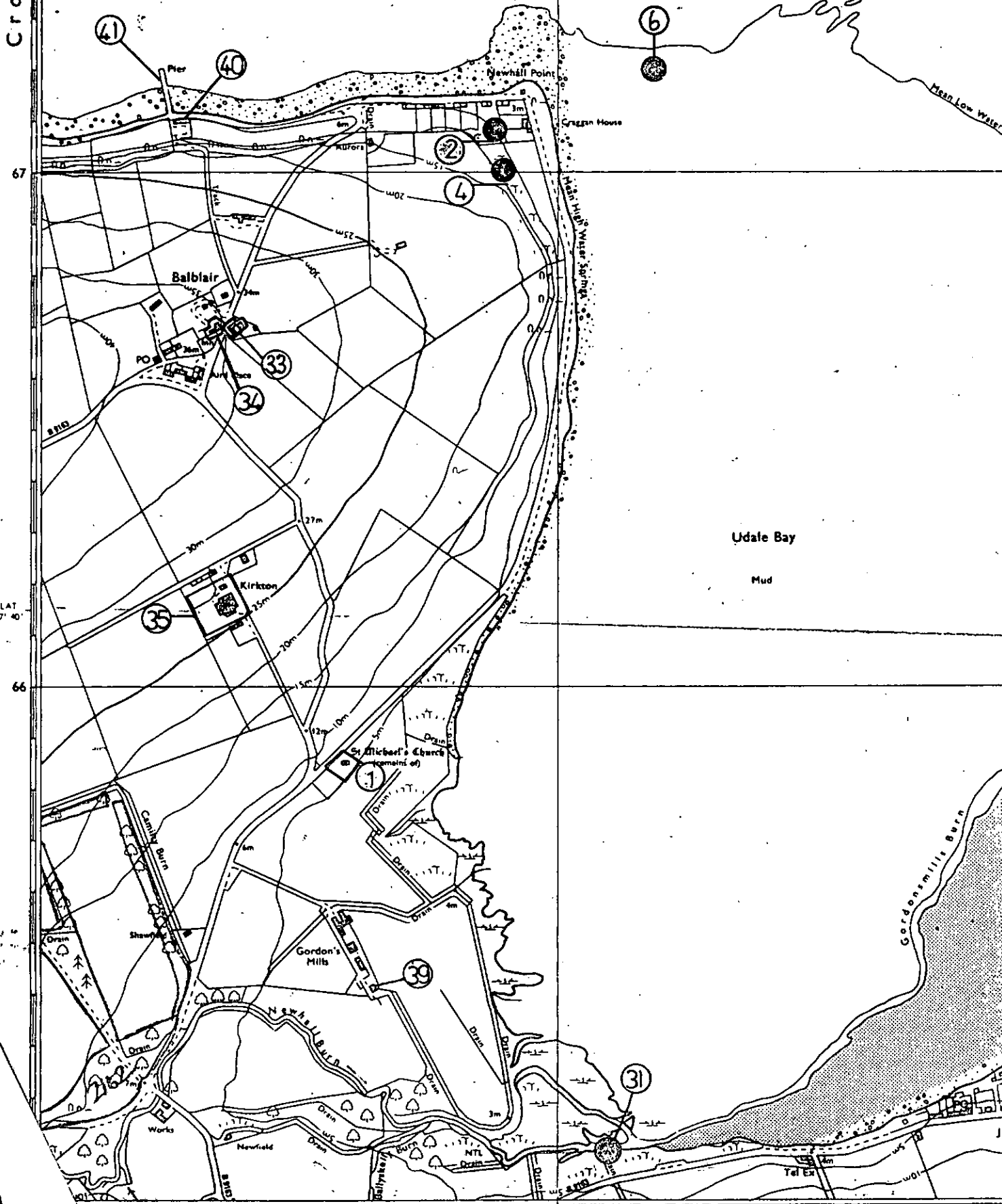

71 65 burial mound + LONG 4° 10' W burial urn

Black Isle
ROSS AND CROMARTY DISTRICT

HIGHLAND REGIONAL COUNCIL
 Plan No. 10/12
 with planning application No. RC/1985/410
 Date of Receipt 14/4/85

HIGHLAND REGIONAL COUNCIL

TOWN AND COUNTRY PLANNING (SCOTLAND) ACT-1972
 This is sheet of the plans consisting of 2 sheets referred to in Consent No. RS/410 issued by the Council under the above Act.

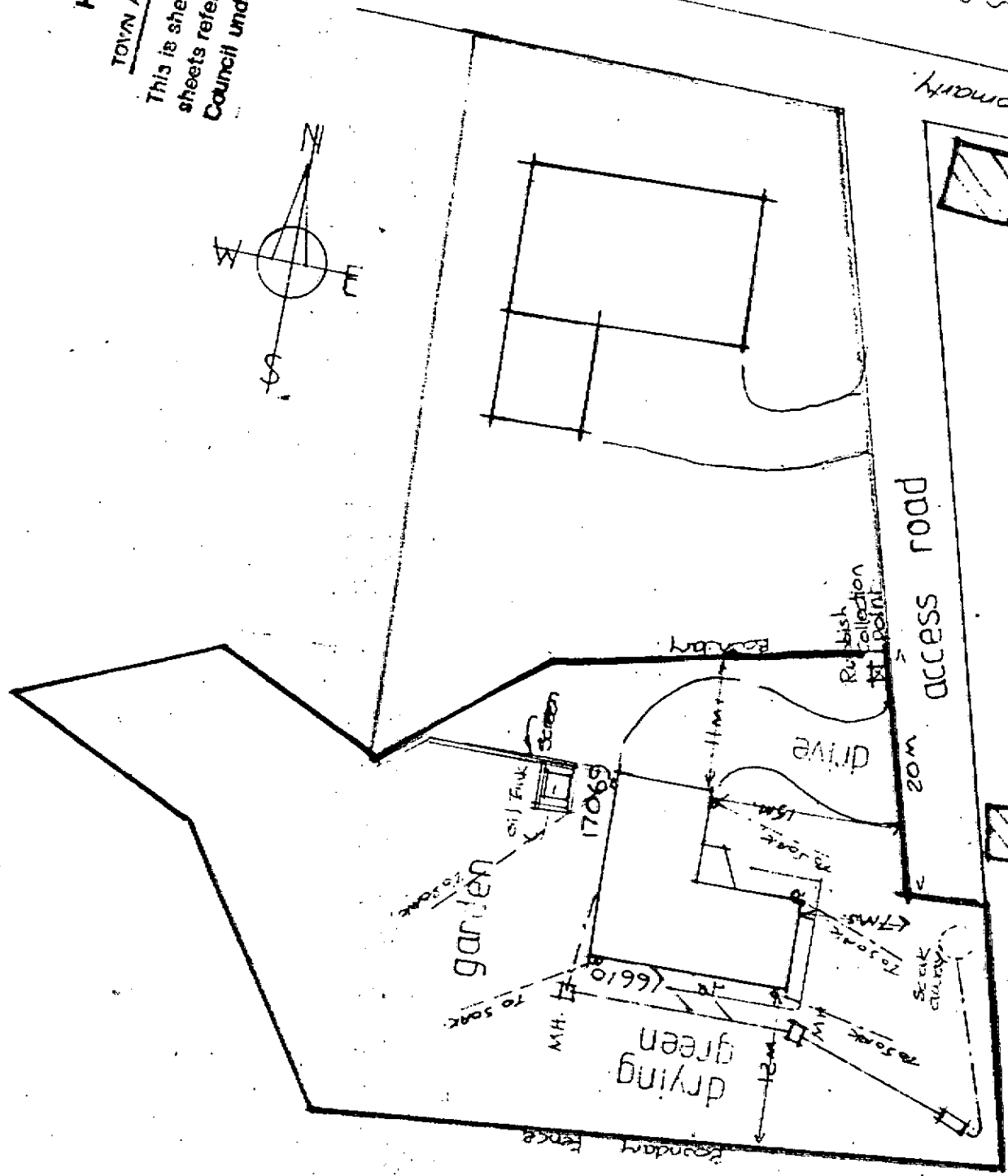
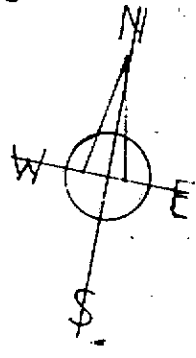

To Newhall

To Comarty

SEA

City

Septic Tank